

JAMES EDWARD

Comprehensively Cared For



The Green Walk

, London, E4 7ER

£5,000 Per Month



The Green Walk



Description

An exquisite five-bedroom family home offering a perfect blend of high-end modern design and spacious living, tucked away behind Chingford Village Green.

- Five Bedrooms
- Very High Specification
- Desirable Location
- Separate Reception Room
- Driveway Parking
- Three Bathrooms
- Huge Garden
- Large Open Plan Kitchen Diner
- Peaceful yet Convenient Street
- Available 1st August





Floor Plan

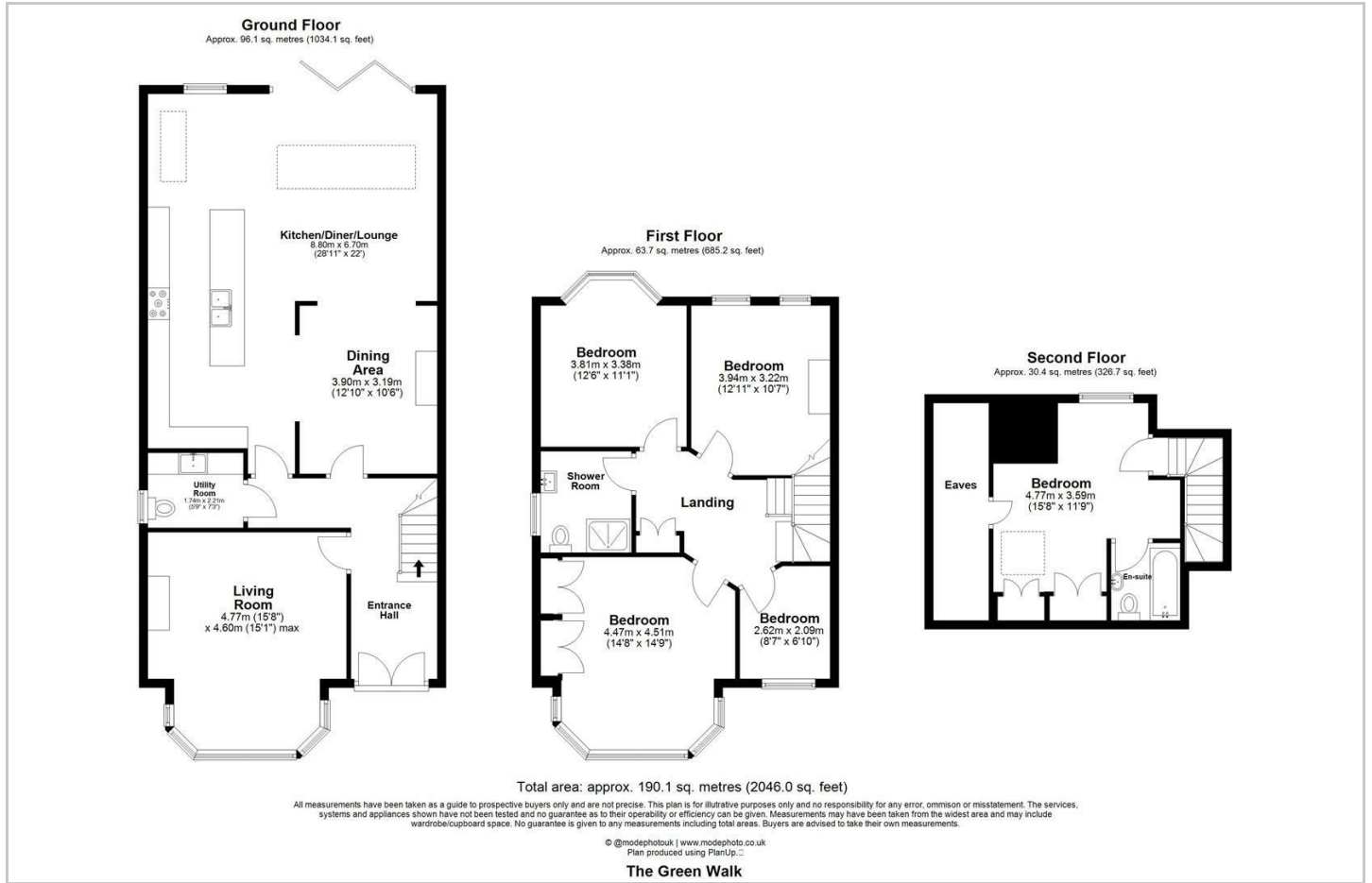

Area Map



Viewing

Please contact our James Edward Office on 020 7952 5197 if you wish to arrange a viewing appointment for this property or require further information.

Energy Efficiency Graph

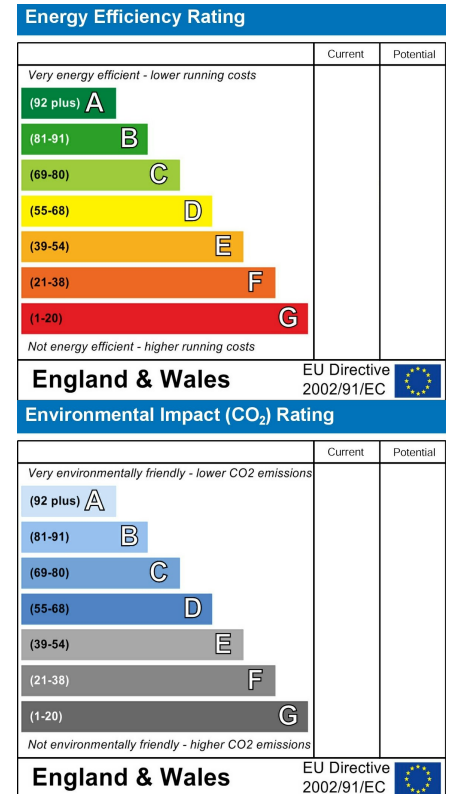

These particulars, whilst believed to be accurate are set out as a general outline only for guidance and do not constitute any part of an offer or contract. Intending purchasers should not rely on them as statements of representation of fact, but must satisfy themselves by inspection or otherwise as to their accuracy. No person in this firm's employment has the authority to make or give any representation or warranty in respect of the property.

100 Highbury Park, London, N5 2XE

Tel: 020 7952 5197 Email: info@jamesedwardproperties.co.uk <https://www.jamesedwardproperties.co.uk>